

ELPARTS

INSTALLATION Connectors | Attachment parts | Cable straps | Gaskets+Grommets |
Insulating tape | Hoses+Pipes | Cables+Cable connections | Battery accessories | Plug housings |
Fuses | Plugs+Sockets | Assortments



herthundbuss.com

ClipFix® Spacer



Poppe
●●○○○

HERTH+BUSS

Clamps

Assortment, spacer	10
Spacer	5 - 9

Spacer



» CLIPFIX



The branded ClassicFix and ClipFix spacers can be used as chafe protection, spacer or damper rings, or as line connectors in almost any vehicle. They are suitable for lines or hoses made of plastic, metal, elastomer and braided steel alike. The material ethylene propylene diene monomer rubber (EPDM) is characterised by its good weather- and ozone-resistance, and is suitable for use in a temperature range from -40 °C to +150 °C. The ClipFixbasic, ClipFixcycle

and ClipFixtwins variants are advanced developments of the ClassicFixbasic model. These products are fastenable and ideally suited for retrofitting in areas with restricted accessibility, among others. The repair-friendly handling, adhesive-free mounting and ease of removal are particular highlights of this range. The ClipFixtwins can connect multiple lines or hoses and are primarily used for holding lines and tolerance compensation for spacing.

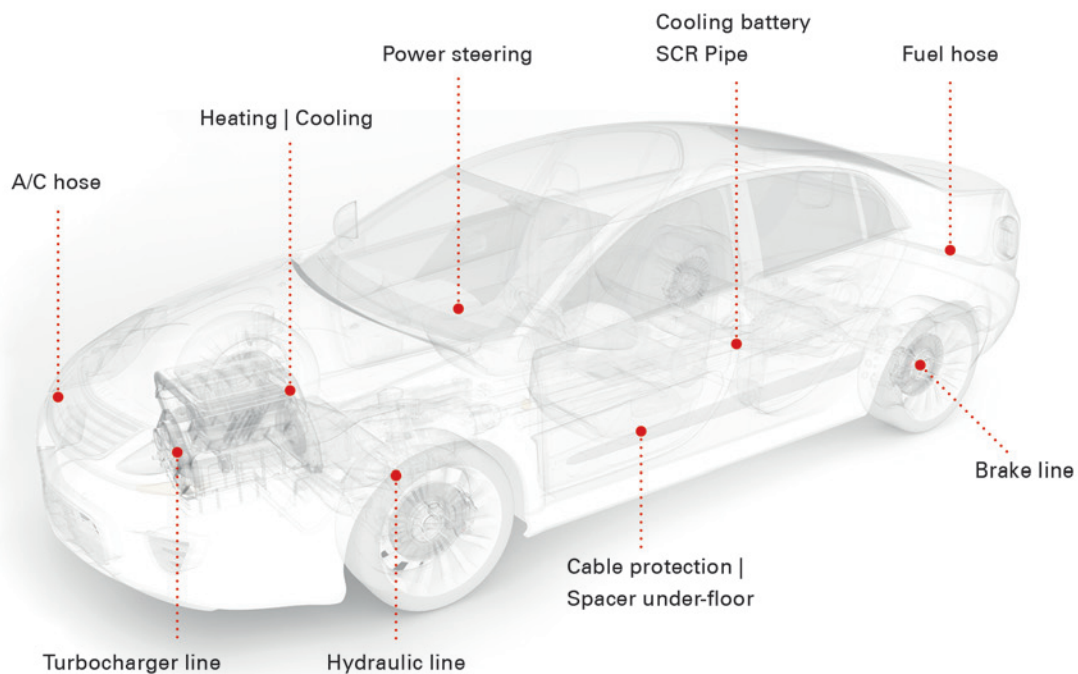

» CLIPFIX MATERIAL OVERVIEW



Durability	EPDM	NBR
Weather	+	-
UV light	+	-
Ozone	+	-
Brake fluid	+	-
Cooling fluid	+	•
Water	+	+
Oil and Grease	-	+
Synthetic oil	-	+
Fuel	-	+
Aliphatic solvent	-	•
Aromatic solvent	-	-
Acid	+	-
Lye	+	-
Temperature	-40 to +120 °C	-35 to +80 °C
Highest short-term temperature	+150 °C	+100 °C

+ suitable • limited suitability - unsuited

All data subject to change.

ClassicFixbasic

Spacer

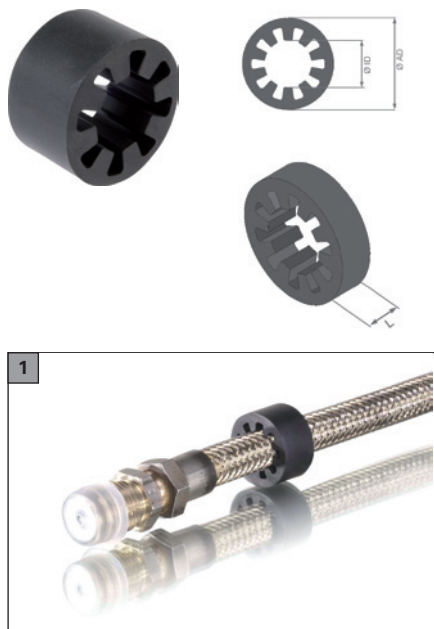

The self-locking ring comprises the basic element of the ClipFix range, which has already been successfully used in the automotive industry for decades. The ring exhibits very good attenuation properties, while its teeth

make it ideally suited to providing tolerance compensation and acting as a thermal insulator. The standard materials are EPDM and NBR.

Manufacturer Restriction:

Poppe
Elastomer

hardness value, base body:

50 Shore-A

Material:

For cable diameter mm	Inner diameter mm	Outer diameter mm	Length mm	DU	Article no.
9,5	9	25	20	1.500	50230825099
10	9,5	19	30	3.000	50230807099
13,5	13	30	15	10	50230808
				2.500	50230808099
		30	40	800	50230809099
15	14,5	26	30	1.500	50230810099
16	15,5	32	20	1.600	50230811099
20,5	19,5	40	20	800	50230812099
21	20,5	32	24	1.500	50230813099
23,5	23	40	20	1.000	50230814099
25,5	25	45	20	750	50230815099
30	29,5	40	20	1.000	50230816099



ClipFixbasic

Spacer

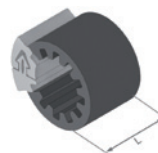
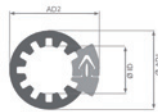

The ClipFixbasic spacers are advanced developments of the basic model. The product is lockable and therefore ideally suited for retrofitting in areas with restricted accessibility, among others. The repair- friendly handling,

adhesive-free mounting and ease of removal are particular highlights of this range. ClipFix rings consist of EPDM material and two components: a hard section for the sealing cap and a soft body for optimum attenuation.

Manufacturer

Poppe

Restriction:

Weatherproof

Design:

Material:

EPDM (ethylene propylene diene Monomer (M-class) rubber)

hardness value, clip:

95 Shore-A

hardness value, base body:

50 Shore-A

Temperature range:

-40 to +120 °C

Highest short-term temperature:

+150 °C

For cable diameter mm	Inner diameter mm	Outer Ø 1 / 2 mm	Length mm	DU	Article no.
5	4	23,5 / 26,5	20	1.500	50230205099
				10	50230306
6	5,2	18 / 21,9	30	1.200	50230306099
				1.000	50230406099
				10	50230308
8	7,5	18 / 22	30	1.500	50230308099
				2.500	50230209099
9	8,5	19 / 23	20	10	50230309
				1.800	50230309099
				10	50230210
10	9,5	20 / 24	20	1.800	50230210099
				1.500	50230310099
				2.000	50230211099
11	10,5	21 / 25	20	10	50230311
				1.500	50230311099
				2.000	50230212099
12	11,5	22 / 26	20	10	50230312
				1.500	50230312099
				30	50230313
13	12,5	23 / 27	30	10	50230313
				1.000	50230313099
15	14,5	25 / 29	15	5.000	50230115099
				1.500	50230215099
				10	50230315
				1.000	50230315099
16	15,5	25,5 / 30,6	20	1	50230316
				10	50230318
18	17	28 / 32	30	1.000	50230318099
				1.300	50230219099
19	18	29 / 33	20	800	50230319099
				10	50230320
20	19	30 / 34	30	1.000	50230320099
				800	50230322099
24	23	34 / 38	20	1.000	50230224099
				10	50230324
				750	50230324099
25	24	35 / 39,6	30	1.000	50230325099
				1.200	50230226099
26	25	37 / 41	20	800	50230326099
				1.000	50230229099
29	28	39 / 43	20	800	50230329099
				900	50230232099
32	31	43,5 / 48	20	900	50230232099

ClipFixcycle

Spacer

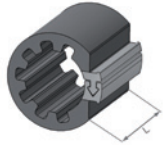
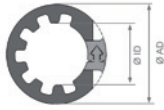

ClipFixcycle spacers are advanced developments of the basic model. The product is lockable and therefore ideally suited for retrofitting in areas with restricted accessibility, among others. The repair-friendly handling, adhesive-free mounting and ease of removal are particular highlights of this range. ClipFix

rings consist of EPDM material and two components: a hard section for the sealing cap and a soft body for optimum attenuation. Furthermore, the clip (hard part) has been incorporated into the outer diameter of the ClipFixcycle, meaning that less space is required overall.

Manufacturer

Poppe

Restriction:

Material:

EPDM (ethylene propylene diene Monomer (M-class) rubber)

hardness value, clip:

95 Shore-A

hardness value, base body:

50 Shore-A

Temperature range:

-40 to +120 °C

Highest short-term temperature:

+150 °C

For cable diameter mm	Inner diameter mm	Outer diameter mm	Length mm	DU	Article no.
8	7,5	20	20	2.400	50230800099
	7,3	22,7	30	1.200	50230801099
11	10,5	22,5	30	1.500	50230823099
16	14,9	25,5	20	1.500	50230802099
18	16,9	25,5	30	10	50230804
				1.500	50230804099
19	19	30	30	1.200	50230806099

» CLIPFIXTWINS

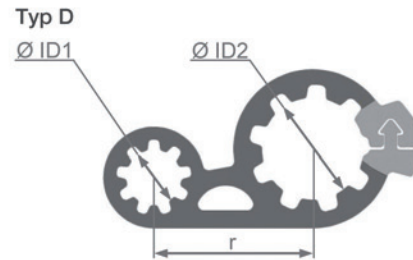
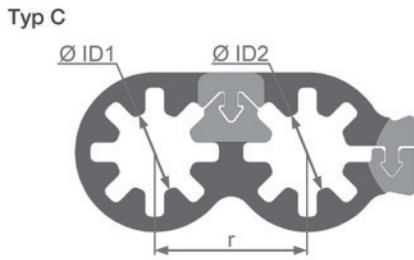
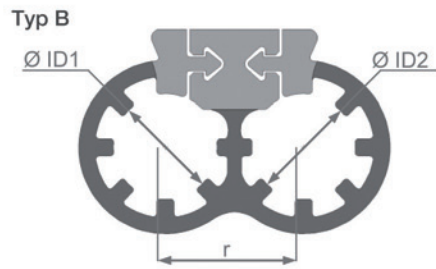
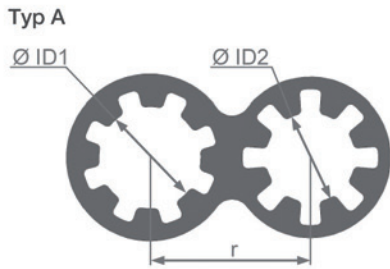

ClipFixtwins

Spacer

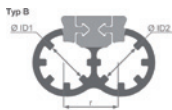

ClipFixtwins spacers are advanced developments of the basic model. The product is lockable and therefore ideally suited for retrofitting in areas with restricted accessibility, among others. The repair-friendly handling, adhesive-free mounting and ease of removal are particular highlights of this range. ClipFix

rings consist of EPDM material and two components: a hard section for the sealing cap and a soft body for optimum attenuation. The ClipFixtwins can connect multiple lines or hoses and are primarily used for holding lines and tolerance compensation for spacing.

Manufacturer:

Poppe

Restriction:

Weatherproof

Design:

Material:

EPDM (ethylene propylene diene Monomer (M-class) rubber)

hardness value, clip:

95 Shore-A

hardness value, base body:

50 Shore-A

Temperature range:

-40 to +120 °C

Highest short-term temperature:

+150 °C



For cable diameter mm	Inner diameter 1 / 2 mm	Length mm	Line centre-to-centre distance mm	Version	DU	Article no.
15	15 / 15	20	20	Typ B	600	50230820099
19	18,5 / 18,5	20	23,5		1.000	50230819099
23	22,5 / 22,5	25	25,5		10	50230817
					600	50230817099
26	25 / 25	25	31		400	50230821099

ClipFixtwins

Spacer

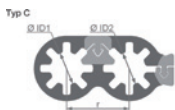

ClipFixtwins spacers are advanced developments of the basic model. The product is lockable and therefore ideally suited for retrofitting in areas with restricted accessibility, among others. The repair-friendly handling, adhesive-free mounting and ease of removal are particular highlights of this range. ClipFix

rings consist of EPDM material and two components: a hard section for the sealing cap and a soft body for optimum attenuation. The ClipFixtwins can connect multiple lines or hoses and are primarily used for holding lines and tolerance compensation for spacing.

Manufacturer	Poppe	hardness value, clip:	95 Shore-A
Restriction:		hardness value, base body:	50 Shore-A
Design:	Weatherproof	Temperature range:	-40 to +120 °C
Material:	EPDM (ethylene propylene diene Monomer (M-class) rubber)	Highest short-term temperature:	+150 °C

for cable diameter 1 / 2 mm	Inner diameter 1 / 2 mm	Length mm	Line centre-to-centre distance mm	Version	DU	Article no.
15 / 17	14 / 16	18	26	Typ C	700	50230822099

ClipFixtwins

Spacer



ClipFixtwins spacers are advanced developments of the basic model. The product is lockable and therefore ideally suited for retrofitting in areas with restricted accessibility, among others. The repair-friendly handling, adhesive-free mounting and ease of removal are particular highlights of this range. ClipFix

rings consist of EPDM material and two components: a hard section for the sealing cap and a soft body for optimum attenuation. The ClipFixtwins can connect multiple lines or hoses and are primarily used for holding lines and tolerance compensation for spacing.

Manufacturer	Poppe	hardness value, clip:	95 Shore-A
Restriction:		hardness value, base body:	50 Shore-A
Design:	Weatherproof	Temperature range:	-40 to +120 °C
Material:	EPDM (ethylene propylene diene Monomer (M-class) rubber)	Highest short-term temperature:	+150 °C

for cable diameter 1 / 2 mm	Inner diameter 1 / 2 mm	Length mm	Line centre-to-centre distance mm	Version	DU	Article no.
15 / 27	14 / 26	20	24,5	Typ D	10	50230818
					1.000	50230818099





ClipFixbasic
ClipFixcycle
ClassicFixbasic
ClipFixtwins

Assortment, spacer

Manufacturer Restriction:
Number of contained variants:

Poppe
15



This assortment contains various elastomer spacers in the most typical sizes for each one. The branded ClassicFix and ClipFix spacers can be used as chafe protection, spacer or damper rings, or as line connectors in almost any vehicle. They are suitable for lines or hoses made of plastic, metal, elastomer and braided steel alike. The material ethylene propylene diene monomer rubber (EPDM) is characterised by its good weather- and ozone-resistance, and is suitable for use in a temperature range from -40 °C to +150 °C. The

ClipFixbasic, ClipFixcycle and ClipFixtwins variants are advanced developments of the ClassicFixbasic model. These products are fastenable and ideally suited for retrofitting in areas with restricted accessibility, among others. The repair-friendly handling, adhesive-free mounting and ease of removal are particular highlights of this range. The ClipFixtwins can connect multiple lines or hoses and are primarily used for holding lines and tolerance compensation for spacing.

Diameter mm	Quantity	DU	Article no.
6 to 24	62	1	54230010
Content	Design	QU	
Assortment Box		1	99994522
Spacer ClassicFixbasic (Poppe)		5	50230808
Spacer ClipFixbasic (Poppe)	Weatherproof	4	50230210
	Weatherproof	4	50230306
	Weatherproof	4	50230308
	Weatherproof	4	50230309
	Weatherproof	2	50230311
	Weatherproof	2	50230312
	Weatherproof	5	50230313
	Weatherproof	5	50230315
	Weatherproof	5	50230318
	Weatherproof	5	50230320
	Weatherproof	5	50230324
Spacer ClipFixcycle (Poppe)		2	50230804
Spacer ClipFixtwins (Poppe)	Weatherproof	5	50230817
	Weatherproof	5	50230818
Accessories	see	DU	
Frame, assortment box HandyBox	Katalog04	1	99994532

ELPARTS



E-catalogues!

Quick, easy, online



- realistic page-turning
- zoom, article search, thumbnail view, table of contents, bookmarks ...
- links and connection to online catalogue
- can be viewed on mobile devices



herthundbuss.com/en/catalogues

Main catalogues



Katalog04EN

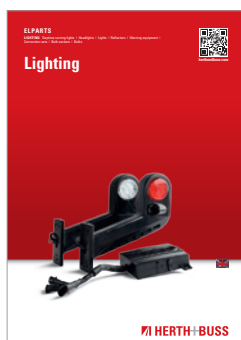

Katalog06EN



Katalog08EN



Katalog13EN

Herth+Buss Fahrzeugteile GmbH & Co. KG
Dieselstraße 2-4 | DE-63150 Heusenstamm

Herth+Buss France SAS
ZA Portes du Vercors, 270 Rue Col de La Chau
FR-26300 Châteauneuf-sur-Isère

Herth+Buss Belgium Sprl
Rue de Fisine 9 | BE-5590 Achêne

Herth+Buss UK Ltd.
Unit 1 Andyfreight Business Pk
Folkes Road, Lye | GB-DY9 8RB Stourbridge

Herth+Buss Iberica
C/A 44 Poligono de Areta
31620 Huarte Navarra | España



4

026736

465384

Brosch15EN | 11-2019

 **HERTH+BUSS**